

**ATTACHMENT VII-5  
SITE MAP WITH GROUNDWATER  
WELLS AND PIEZOMETERS**

DRAFT

M:\clients\Cameron-Cole\1815-Grassy-Mtn\2021\GM-Site-092921.dwg

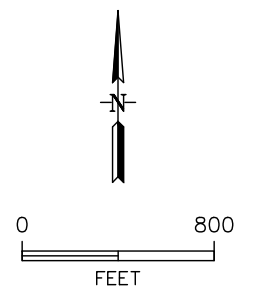
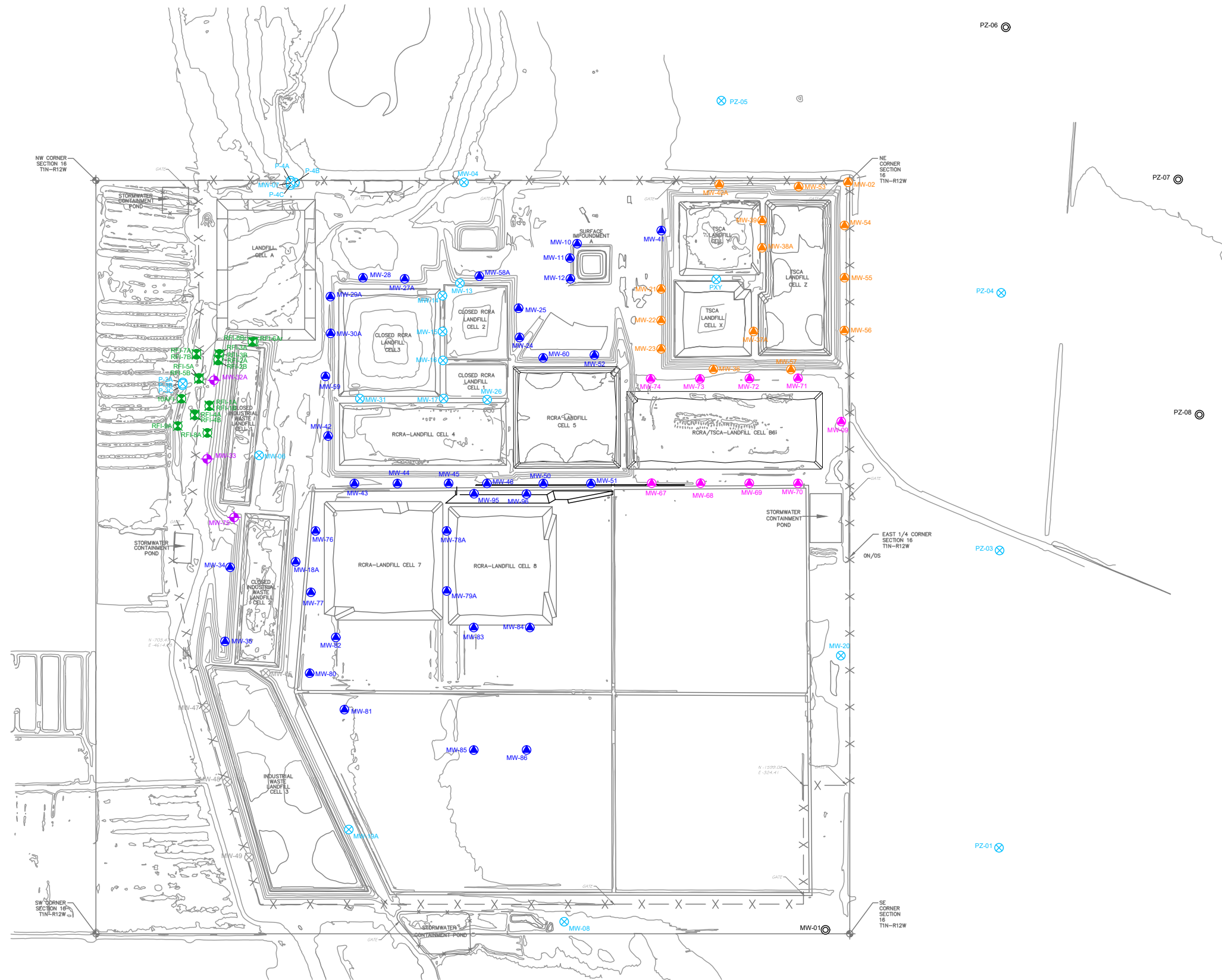

**LEGEND**

- POC GROUNDWATER MONITORING WELL
- TSCA MONITORING WELL
- RCRA/TSCA MONITORING WELL
- ⊕ COMPLIANCE WELL
- ⊗ RFI WELL
- ⊙ BACKGROUND MONITORING WELL
- ⊗ PIEZOMETER (water level measurements only)
- ⊗ WELL ABANDONED JULY 2021
- TOPOGRAPHIC SURFACE CONTOUR

• All wells were surveyed on April 2021 for northing, easting, and top of casing elevations.

BY	DATE
DRAWN JGM	09/29/21
CHECKED	
REVISED	
REVISED	
APPROVED	
APPROVED	
APPROVED	



**Cameron-Cole**  
 5777 CENTRAL AVENUE, SUITE 200  
 BOULDER, COLORADO 80301  
 PHONE: (303) 938-5500  
<http://www.cameron-cole.com>

Attachment VII-5

**SITE MAP WITH GROUNDWATER WELLS AND PIEZOMETERS**

**CLEAN HARBORS GRASSY MOUNTAIN, LLC**

SCALE:	1" = 800'	PROJECT:	1815
--------	-----------	----------	------